



**DK COMMERCIAL**

*Boise, Idaho*

## **OFFICE/SHOW/WHSE FOR LEASE**



# **1404 W. IDAHO STREET**

**LOCATION:** Downtown

**BUILDING SIZE:** 7,179 SQ. FT.

**ZONING:** C-2 D

**TERM:** 3-5 YEARS

**LEASE TYPE:** NNN

**ESTIMATED NNN EXPENSES:** \$ .14 PER SQ. FT.

**AVAILABLE SUITES:**

Ste. 104 2,142 Sq. Ft. Total

535 Sq. Ft. Office

1,607 Sq. Ft. Whs w/ HVAC

**RATE:**

**\$1499.00/mo NNN**

**AMENITIES:**

- ◆ Easy access to major arterials
- ◆ Great Downtown Location
- ◆ 240 single phase
- ◆ Tenant Improvements Negotiable

**FOR MORE INFORMATION CONTACT:**

**BRENDA CLAY - CELL: 208-371-5804**

**OFFICE: 208-955-1015 \* FAX: 208-888-1828 \* EMAIL: [BRENDACLAY@CABLEONE.NET](mailto:BRENDACLAY@CABLEONE.NET)**

**1880 SOUTH COBALT POINT WAY SUITE 200 MERIDIAN, ID 83642 [WWW.DKCOMMERCIAL.COM](http://WWW.DKCOMMERCIAL.COM)**

CREATED 07.08.08

The information contained herein has been obtained by reliable sources, but is not guaranteed. This offering is subject to errors, and omissions, prior sale, price change and withdrawal.



**DK COMMERCIAL**

*Boise, Idaho*

# 1404 W. IDAHO STREET

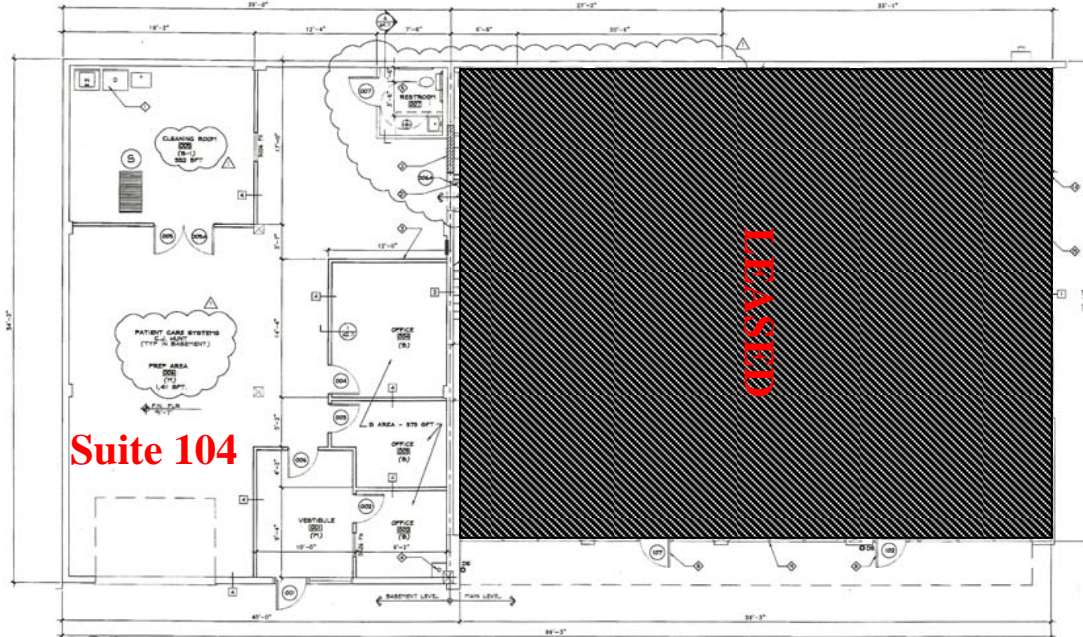

**FOR MORE INFORMATION CONTACT:**

**BRENDA CLAY - CELL: 208-371-5804**

**OFFICE: 208-955-1015 \* FAX: 208-888-1828 \* EMAIL: [BRENDACLAY@CABLEONE.NET](mailto:BRENDACLAY@CABLEONE.NET)**

**1880 SOUTH COBALT POINT WAY SUITE 200 MERIDIAN, ID 83642 [WWW.DKCOMMERCIAL.COM](http://WWW.DKCOMMERCIAL.COM)**

CREATED 07.08.08

The information contained herein has been obtained by reliable sources, but is not guaranteed. This offering is subject to errors, and omissions, prior sale, price change and withdrawal.